

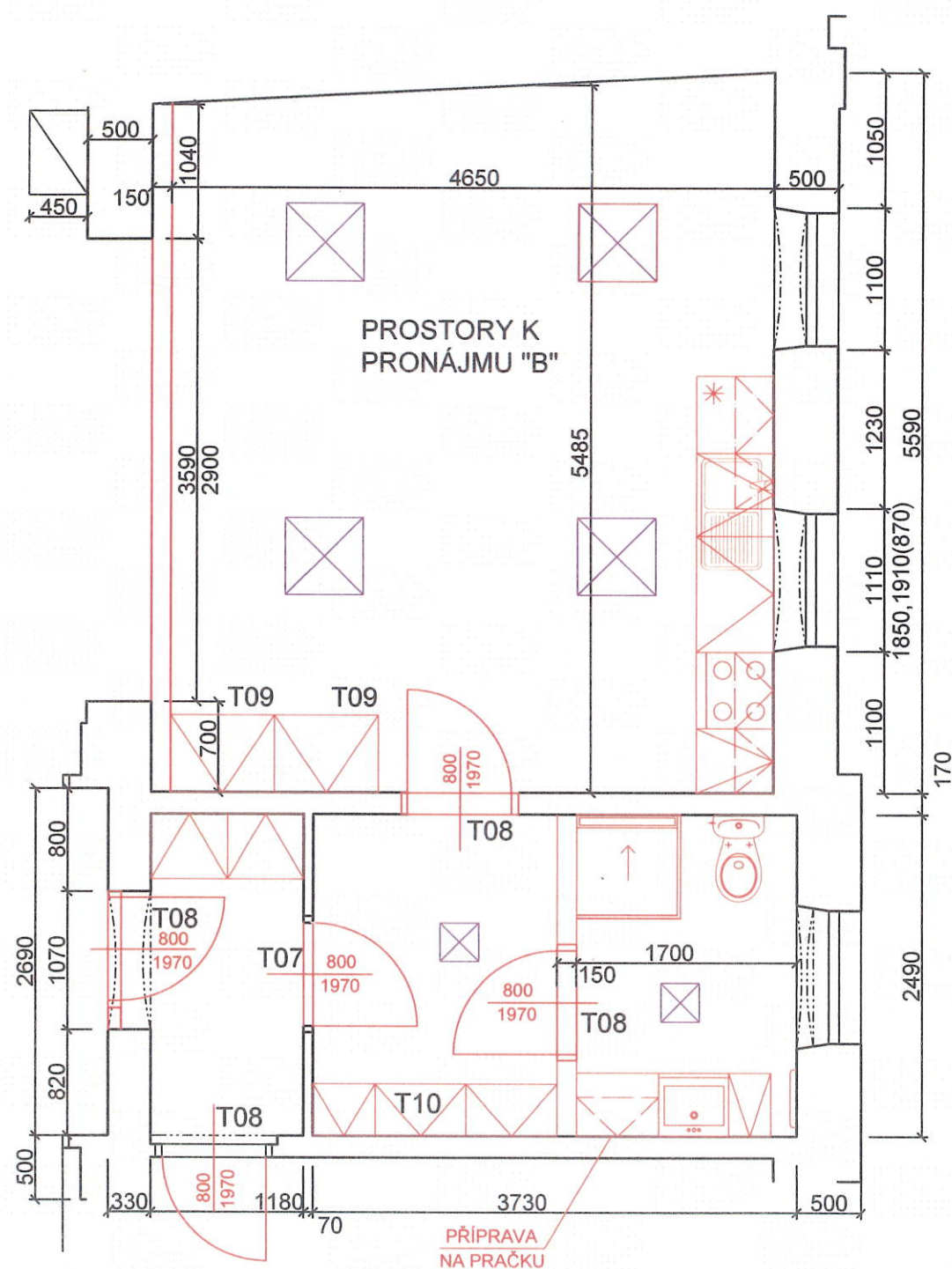

PŪDORYS



— NOVÁ KONSTRUKCE-VIDITELNÁ HRANA

NOVÁ SVÍTIDLA



BARVA:NEREZ/MAT



DEKOR
TABÁK
NÁBYT



BARVA.CHROM



DEKO
TABÁK
NÁBYT

DAKVA.STRUM

BARVA:NEREZ/MAT

Technical drawing of a rectangular structure. The overall width is 800 and the overall height is 2100. A central vertical line divides the structure. Horizontal dashed lines are shown at the top and bottom. A note '2020' is present on the right side, indicating a specific height or distance.

Figure 1 is a schematic diagram of the layout of the experimental facility. It shows a rectangular area with a total height of 2100 and a total width of 700 + 700 + 480. The layout is divided into sections by dashed lines. In the center, there is a small table with two chairs on each side. The diagram is labeled with dimensions and section numbers.

VYPRACOVAL:	Simona MOLEDOVÁ	DATUM:	03/2025
NÁZEV STAVBY:	Opava-Vávrovice	MĚŘÍTKO:	1:50
NÁZEV VÝKRESU:	NÁVRH INTERIÉRU DŮM SLUŽEB-2.NP. PROSTORY K PRONÁJMU "B" -TRUHLÁŘSKÉ VÝROBKY	Č.VÝKRESU:	D.2.2.03.